

WINDOW ASSEMBLY

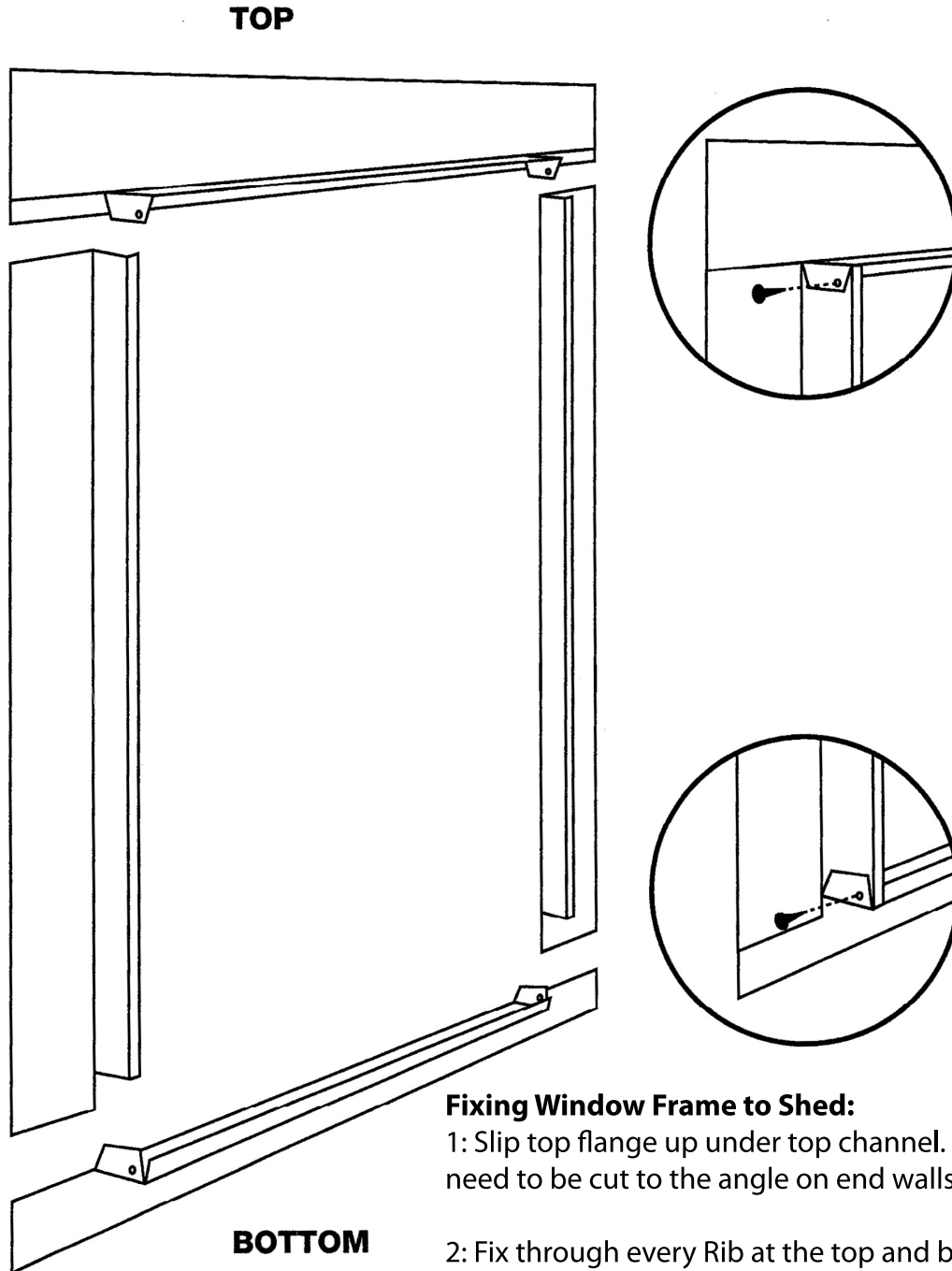

Diagram is viewing window parts for assembly from the inside of the shed.



Fixing Window Frame to Shed:

1: Slip top flange up under top channel. (This will need to be cut to the angle on end walls)

2: Fix through every Rib at the top and bottom and 150mm centres up the sides.

3: Fit Louvre fittings (if supplied) through window frames.