

Doors in gable end wall

ASSEMBLY INSTRUCTIONS



Please read these instructions in conjunction with your standard shed instructions

1. Layout doors and sheets appropriate for your customised shed.
2. Cut the top channel in the centre as per gable end wall instructions for a standard shed. Fit top channel to angle.
3. Fit bottom channel as standard. Measure opposite end wall to make sure both end walls end up the same height at the peak. Attach to sheets where possible according to standard shed instructions.
4. Fit top door spacer between door jambs approx 10mm above the top of the doors. Fix to door jambs at each end then fit the 'Z' plate. The 'Z' plate is designed to stop water from entering the shed from extreme angles. See **Z PLATE** diagram for fitting instructions.
5. Place nuts supplied between the interior of the shed wall and the padbolt to ensure that it does not catch on the 'Z' piece. (**SEE NOTE**).
6. Attach (A) flat sheet to top channel, door jambs and door spacer around the perimeter at approximately 300mm centres.
7. Finish as per standard instructions where necessary.

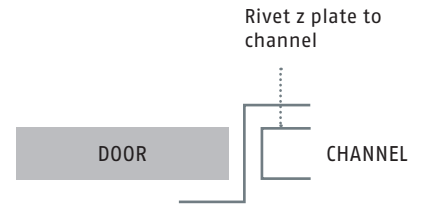

Z PLATE: The 'Z' plate slides under the door and in front of the channel to stop rain from entering the shed from extreme angles.

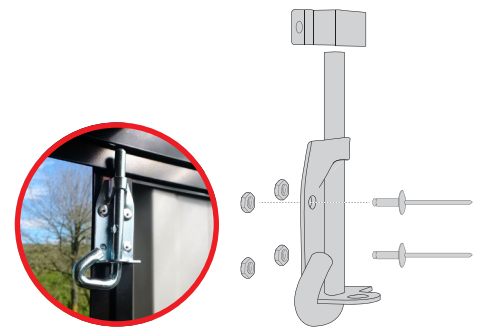

NOTE: Place nuts supplied between the interior of the shed wall and the padbolt to ensure that it does not catch on the 'Z' piece.

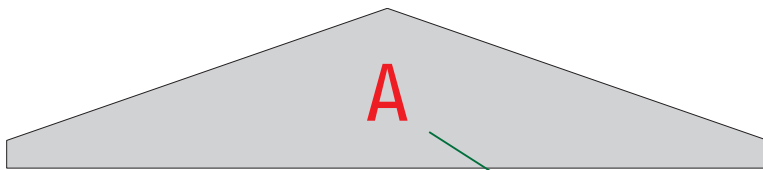

SCAN TO
WATCH OUR
ASSEMBLY VIDEO
HERE

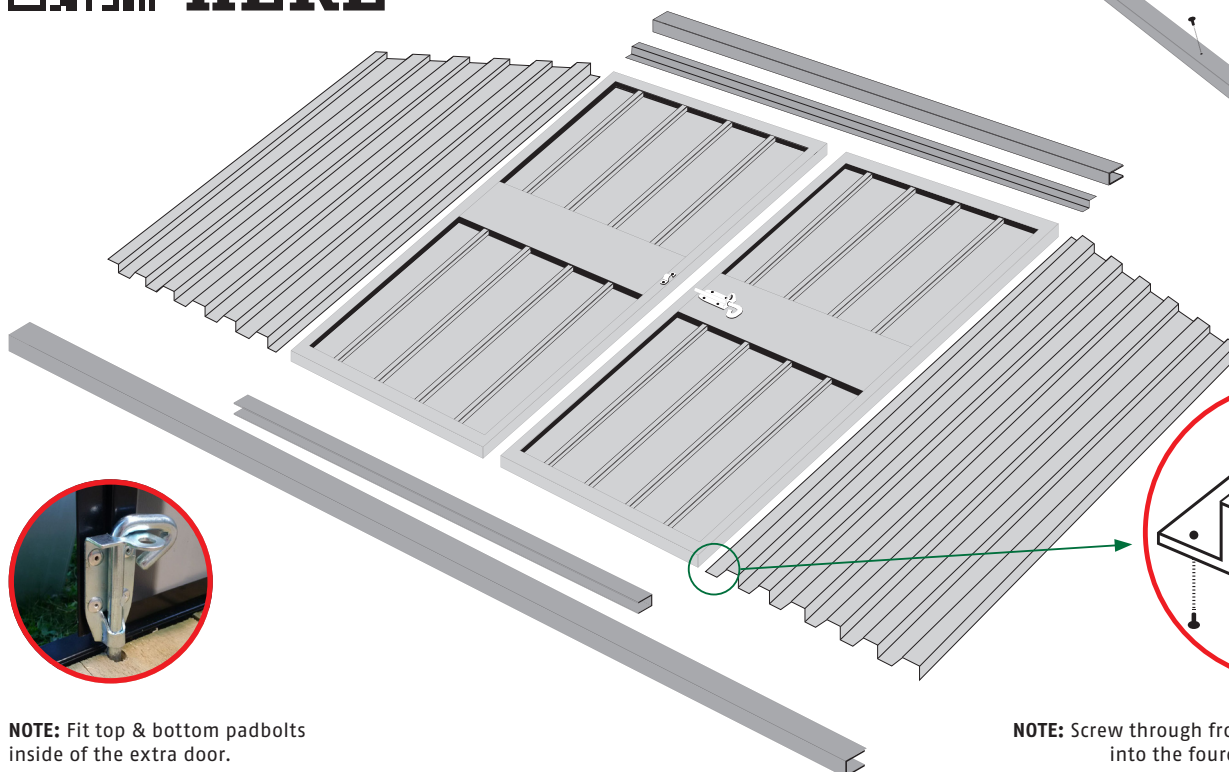
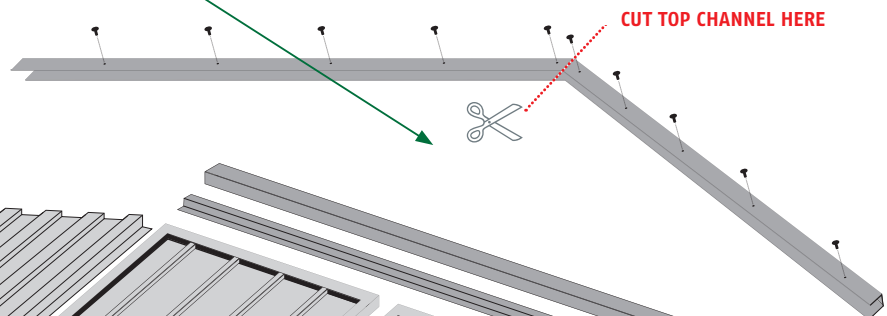

NOTE: Fit top & bottom padbolts inside of the extra door.

NOTE: Screw through front and back of channel into the four corners of the doorway.